

The background of the entire page is a photograph of a chain-link fence. A large, silver Master Lock padlock is attached to a metal post on the right side of the fence. The padlock has the word "Master" embossed on its front. The fence is made of interlocking metal rings. The overall color scheme is dominated by the purple of the text boxes and the silver of the metal.

**Master
Lock®**

**TOUGH
UNDER
FIRE**

A small icon of a Master Lock padlock, showing the brand name and a keyhole.

INDUSTRIAL

LOCK CUSTOMISATION

KEY SYSTEMS

PRO SERIES® PADLOCKS

LAMINATED PADLOCKS

STAINLESS STEEL PADLOCKS

BRASS PADLOCKS

COMBINATION PADLOCKS

BLUETOOTH PADLOCKS

HASPS & STAPLES

CABLE & CHAIN

KEY CABINETS

LOCK CUSTOMISATION

WHO IS THE MASTER LOCK INDUSTRIAL/COMMERCIAL PROGRAM FOR?

The Master Lock Industrial/Commercial Program is specifically designed with the high volume commercial end user's needs in mind.

The Master Lock Industrial/Commercial Program offers security solutions that can be customised for end user specific applications.

The products offered allow you to choose the best width, material, shackle diameter and length along with the right design for your application and fast delivery for your job.

Multiple keying options and custom marking programs add value to the "Built-To-Order" program.

SECURITY ENHANCEMENTS

Edge™ Restricted Key Control System

Enhance the security of your facility with the exclusive Edge™ Restricted Key Control System. The patented Edge™ system makes key-controlled security a cost-effective possibility for virtually any facility and application.



Keys are completely restricted and are available only via an authorised dealer, making unauthorised duplication impossible.

BlockGuard® Anti-Shim Technology

Continuing to lead the market with innovative security solutions, Master Lock now offers the patent-pending BlockGuard® Anti-Shim Technology.

These enhanced combination locks deter shimming, a method of compromising a lock by inserting a shim tool into its latch mechanism. Master Lock exclusive BlockGuard™ Anti-Shim Technology is now available on combination padlock models 1500 (boxed), 1502 and 1525 with supervisory key control.



OPTION YOUR MASTER LOCK SECURITY SYSTEM

For Best Performance & Long Life

Ownership Identification

Prevent theft and wasted time searching for the right key or the assigned employee. You can permanently identify ownership and access rights on the padlocks themselves. Master Lock will custom engrave text and logos to meet your needs.



Specifications

All sizes quoted in the list are nominal metric sizing for imperial measurements. For accurate & detailed imperial sizes of products please contact your Mayo Hardware representative.

Key Charting

Master Lock maintains key record information for registered commercial lock systems so you can be assured that there is no unwanted key duplications with locks that you purchase over time. Request this special service at no charge when placing your order. ^Δ

Keying

Master Lock products, in most cases, are available in keyed alike & master keyed formats either ex-stock or built to your exclusive order requirements in our keying cell. For details on all options please contact your Mayo Hardware representative.

^Δ Conditions apply

BASIC STANDARD KEYING OPTIONS

Note: Keyed to Differ is the standard keying on all locks.

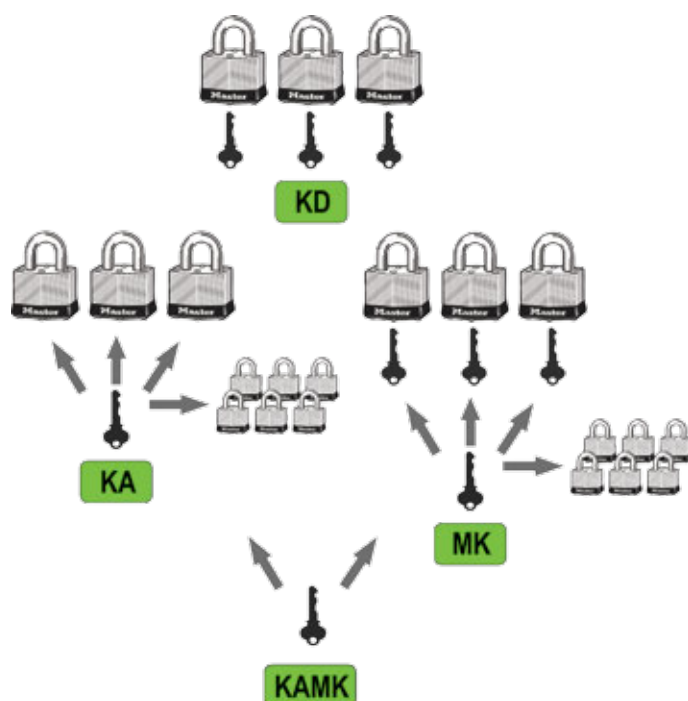

Lifetime Warranty

- **Keyed To Differ (KD)** – Each lock is opened by its own unique key that does not open any other lock in the set. Keyed to differ is the standard keying on Master Lock padlocks.
- **Keyed Alike (KA)** – This option provides "same key" convenience and eliminates the need for multiple keys where numerous padlocks are used. All padlocks in the set are opened by the same key.
- **Master Keyed (MK)** – In a Master Keyed System, a master key opens all the locks in the system although each lock has its own unique key. This permits overriding master key systems along departmental or other functional lines, to allow supervisory access.

More options on keying and system integration are available. Please contact your Mayo Hardware representative for full details.

KEY PROFILE & CYLINDER OPTIONS FOR MASTER LOCK PRO SERIES



W27 Profile – 5 pin keyway is the standard Cylinder inclusion in the Pro Series Padlock range. Key blanks are available.



W7000 offers 6 pin key security with over 260,000 key changes. Offers strong pick resistance and increased code availability.



WP6 Edge Restricted Cylinder makes unauthorised key duplication impossible.

PRO SERIES® REKEYABLE PADLOCKS

Pro Series® Rekeyable Padlocks For Use With Master Lock Profiles

Pro Series® with Master Lock profiles offer the largest range while solving your security needs with the best value proposition.

- Hardened boron alloy shackles for superior cut resistance.
- Dual ball bearing locking mechanism resists pulling and prying.
- High security cylinder.
 - 5-pin and 6-pin cylinders provide tens of thousands of key changes
 - Spool pins are virtually impossible to pick
- Rekeyable – replaceable cylinder and shackle.

6100 SERIES WEATHER TOUGH® PADLOCKS



6121

6127

- Ideal for harsh outdoor conditions.
- Exclusive cover protects lock from water, ice, dirt and grime.
- Heavy duty steel bodies withstand physical attacks.
- Keyway cover keeps out dust and dirt.
- Coloured covers available via special order on 6121.
- Lifetime warranty.

TIP

For added pick resistance upgrade your padlocks to the Master Lock 6 pin W7000 profile – Item Code: 6PINCHARGE

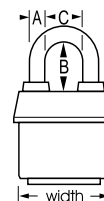

Item Code	Description	Pack Qty	Min. Order Qty	Shackle Dimensions (Metric)		
				A	B	C
6121K	Weather Tough 54mm Wide Body – Boron Shackle – Keyed to W27 Cylinder	6	1	8mm	29mm	22mm
6121LFK	Weather Tough 54mm Wide Body – Boron Shackle – Keyed to W27 Cylinder	6	1	8mm	38mm	22mm
6121LJK	Weather Tough 54mm Wide Body – Boron Shackle – Keyed to W27 Cylinder	6	1	8mm	63mm	22mm
6121LNK	Weather Tough 54mm Wide Body – Boron Shackle – Keyed to W27 Cylinder	6	1	8mm	143mm	22mm
6121BK	Weather Tough 54mm Wide Body – Brass Shackle – Keyed to W27 Cylinder	6	1	8mm	29mm	22mm
6121BLJK	Weather Tough 54mm Wide Body – Brass Shackle – Keyed to W27 Cylinder	6	1	8mm	63mm	22mm
6121SSK	Weather Tough 54mm Wide Body – Stainless Steel Shackle – Keyed to W27 Cylinder	6	1	8mm	30mm	22mm
6121SSLJK	Weather Tough 54mm Wide Body – Stainless Steel Shackle – Keyed to W27 Cylinder	6	1	8mm	60mm	22mm
6125K	Weather Tough 61mm Wide Body – Boron Shackle – Keyed to W27 Cylinder	6	1	10mm	35mm	22mm
6125LJK	Weather Tough 61mm Wide Body – Boron Shackle – Keyed to W27 Cylinder	6	1	10mm	63mm	22mm
6127K	Weather Tough 67mm Wide Body – Boron Shackle – Keyed to W27 Cylinder	6	1	11mm	35mm	22mm
6127LHK	Weather Tough 67mm Wide Body – Boron Shackle – Keyed to W27 Cylinder	6	1	11mm	48mm	22mm
6127LJK	Weather Tough 67mm Wide Body – Boron Shackle – Keyed to W27 Cylinder	6	1	11mm	63mm	22mm

Note: All locks and cylinders supplied Keyed to Differ unless otherwise specified.



6121- 6 different colour options available

Distributed exclusively by

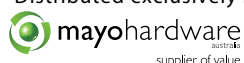

CALL 1300 360 211

6300 SERIES HIGH SECURITY – SOLID IRON SHROUDED PADLOCKS



6325

6327

- Heavy steel bodies withstand physical attacks.
- Iron shroud protects shackle from cutting and prying.
- Lifetime warranty.

TIP

For added pick resistance upgrade your padlocks to the Master Lock 6 pin W7000 profile – Item Code: 6PINCHARGE

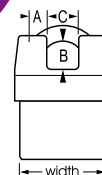

Item Code	Description	Pack Qty	Min. Order Qty	Shackle Dimensions (Metric)		
				A	B	C
6321K	High Security Solid Iron Shrouded 54mm Wide Body – Boron Shackle – Keyed to W27 Cylinder	6	1	8mm	19mm	22mm
6325K	High Security Solid Iron Shrouded 61mm Wide Body – Boron Shackle – Keyed to W27 Cylinder	6	1	10mm	19mm	22mm
6327K	High Security Solid Iron Shrouded 67mm Wide Body – Boron Shackle – Keyed to W27 Cylinder	6	1	11mm	19mm	22mm

7000 SERIES HIGH SECURITY – SOLID STEEL PADLOCKS



7030

7050

7045

- Heavy case hardened steel body.
- Chrome rust proofing provides longer life.
- Shrouded model protects against bolt cutters and prying.
- Lifetime warranty.

TIP

For added pick resistance upgrade your padlocks to the Master Lock 6 pin W7000 profile – Item Code: 6PINCHARGE

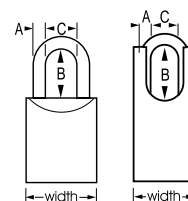

Item Code	Description	Pack Qty	Min. Order Qty	Shackle Dimensions (Metric)		
				A	B	C
7030K	Solid Steel 40mm Wide Body – Boron Shackle – Keyed to W27 Cylinder	6	1	6mm	27mm	20mm
7030LFK	Solid Steel 40mm Wide Body – Boron Shackle – Keyed to W27 Cylinder	6	1	6mm	40mm	20mm
7030LTK	Solid Steel 40mm Wide Body – Boron Shackle – Keyed to W27 Cylinder	6	1	6mm	76mm	20mm
7040K	Solid Steel 44mm Wide Body – Boron Shackle – Keyed to W27 Cylinder	6	1	8mm	30mm	23mm
7040LFK	Solid Steel 44mm Wide Body – Boron Shackle – Keyed to W27 Cylinder	6	1	8mm	40mm	23mm
7040LJK	Solid Steel 44mm Wide Body – Boron Shackle – Keyed to W27 Cylinder	6	1	8mm	61mm	23mm
7040LNK	Solid Steel 44mm Wide Body – Boron Shackle – Keyed to W27 Cylinder	6	1	8mm	143mm	23mm
7040SSK	High Security Solid Steel 44mm Wide Body – Stainless Steel Shackle – Keyed to W27 Cylinder	6	1	8mm	30mm	22mm
7040SSLJK	High Security Solid Steel 44mm Wide Body – Stainless Steel Shackle – Keyed to W27 Cylinder	6	1	8mm	60mm	22mm
7050K	Solid Steel 51mm Wide Body – Boron Shackle – Keyed to W27 Cylinder	6	1	10 mm	37mm	23mm
7050LJK	Solid Steel 51mm Wide Body – Boron Shackle – Keyed to W27 Cylinder	6	1	10mm	63mm	23mm
7045K	Solid Steel Shrouded 44mm Wide Body – Boron Shackle – Keyed to W27 Cylinder	6	1	8mm	30mm	23mm

Note: All locks and cylinders supplied Keyed to Differ unless otherwise specified.

PRO SERIES® REKEYABLE PADLOCKS

6800 SERIES – HIGH SECURITY SOLID BRASS PADLOCKS



6840K

6840LJK

6840BK

6840BLJK

- Solid brass body provides resistance in caustic, corrosive and salty environments.
- Extended boron, brass and stainless steel shackles available.
- Lifetime warranty.

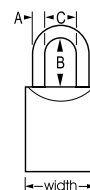

Item Code	Description	Pack Qty	Min. Order Qty	Shackle Dimensions (Metric)		
				A	B	C
6840K	Solid Brass 40mm Wide Body – Boron Shackle – Keyed to W27 Cylinder	6	1	8mm	30mm	23mm
6840LFK	Solid Brass 40mm Wide Body – Boron Shackle – Keyed to W27 Cylinder	6	1	8mm	40mm	23mm
6840LJK	Solid Brass 40mm Wide Body – Boron Shackle – Keyed to W27 Cylinder	6	1	8mm	62mm	23mm
6840LNK	Solid Brass 40mm Wide Body – Boron Shackle – Keyed to W27 Cylinder	6	1	8mm	143mm	23mm
6840BK	Solid Brass 40mm Wide Body – Brass Shackle – Keyed to W27 Cylinder	6	1	8mm	30mm	23mm
6840BLJK	Solid Brass 40mm Wide Body – Brass Shackle – Keyed to W27 Cylinder	6	1	8mm	62mm	23mm
6840SSK	Solid Brass 40mm Wide Body – Stainless Steel Shackle – Keyed to W27 Cylinder	6	1	8mm	30mm	23mm
6840SSLJK	Solid Brass 40mm Wide Body – Stainless Steel Shackle – Keyed to W27 Cylinder	6	1	8mm	62mm	23mm

6200 SERIES – ROUND BODIES – SOLID STEEL PADLOCKS



6230K

- 64mm wide, hardened solid steel body.
- Hardened boron alloy shackle for superior cut resistance.
- 5 and 6 spool pin tumbler cylinder for added pick resistance.
- High security padlock resists tough abuse.
- Lifetime warranty.

TIP

For added pick resistance upgrade your padlocks to the Master Lock 6 pin W7000 profile – Item Code: 6PINCHARGE



Item Code	Description	Pack Qty	Min. Order Qty	Shackle Dimensions (Metric)		
				A	B	C
6230K	Solid Steel 64mm Wide Body – Boron Shackle – Keyed to W27 Cylinder	6	1	11mm	28mm	22mm
6230LHK	Solid Steel 64mm Wide Body – Boron Shackle – Keyed to W27 Cylinder	6	1	11mm	51mm	22mm

Distributed exclusively by

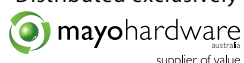

CALL 1300 360 211

PUCK LOCK – HIDDEN SHACKLE PADLOCKS



- Ideal for vans, trucks, gates and vending.
- Defeats attempts to pry and cut.
- Hardened solid steel lock body withstands forcible attacks.
- Complete with high security 6-pin Pro Series® cylinder.
- Lifetime warranty.



Item Code	Description	GTIN	Pack Qty	Min. Order Qty	Shackle Dimensions (Metric)		
					A	B	C
6270	Solid Steel 73mm Enclosed Shackle Complete With 7000 Cylinder	071649025068	6	1	9mm	N/A	N/A
USE WITH FOLLOWING HASPS					Hasp Length		
0770	Enclosed Solid Steel Hasp For 6270	071649033759	-	1	230mm		
730DPFAU	Straight Bar Hasp 180mm Length	071649042737	4	4	180mm		



CHECK LIST

Item Code	Description
Component & Upgrade Options	
CUTKEYCOM	Extra Cut Keys
HSK	Hard Stamp Numbering On Keys
KACHARGE	Keyed Alike to Specific Key Code Per Padlock
MKCHARGE	Master Keying Charge Per Padlock
KRCHARGE	Key Retaining Charge Per Padlock
ENGCOM	Engraving Per Side

EDGE™ RESTRICTED KEY CONTROL

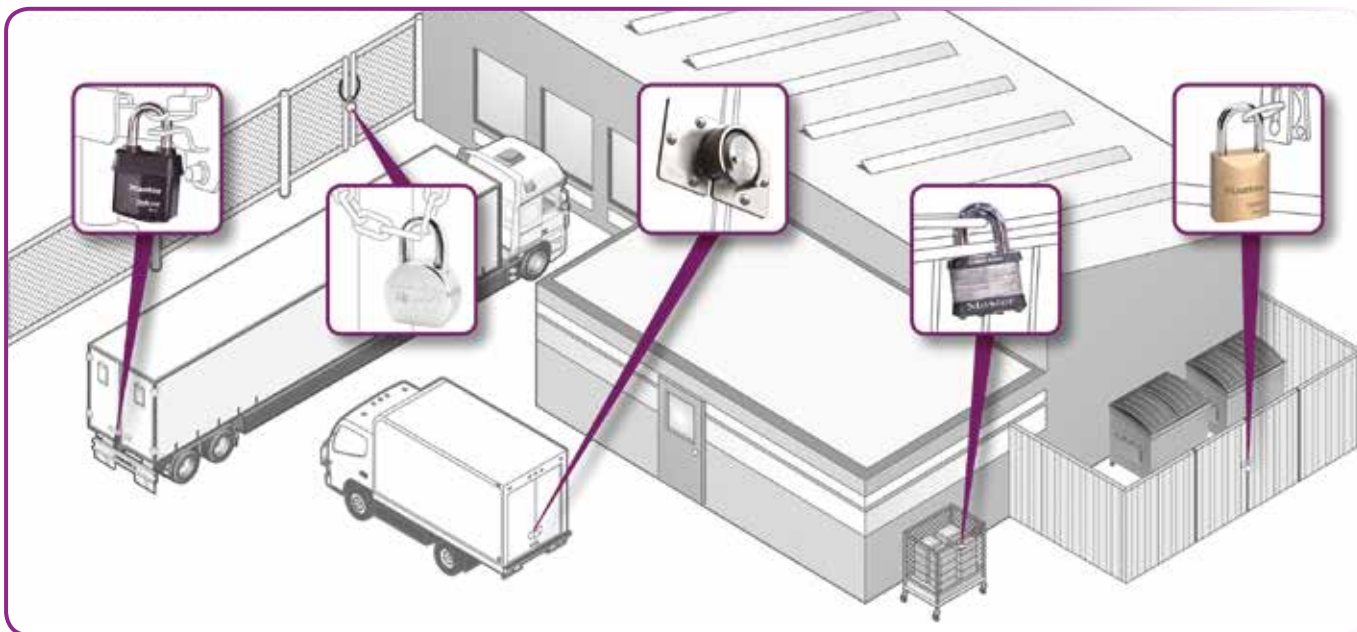

Edge™ KEY CONTROL



Padlocks are an important, effective and often overlooked cornerstone of security. Edge™ Control System gives companies confidence and control over the integrity of their padlock security network.

- Control and eliminate unauthorised key duplication
- Keys available only from Master Lock – copies cannot be made at stores
- Implement a single keying system across all padlock security applications

Build Your Master Lock Edge™ Padlock

1. Select Base Model

2. Select Keying Format

KD = Keyed Differ (Standard)

KA = Keyed Alike

MK = Master Keyed†

KAMK = Keyed Alike Master Keyed†



Example:

1. Base Model: 6121LFWP6

2. Keying: KD

3. No Of Keys: 1K

Finished Product Code: 6121LFWP6KD1K

3. Select No. Of Keys Required Per Lock

NK = 0 keys per lock

1K = 1 key per lock

2K = 2 keys per lock

† Note: Extra cost per Master Keyed Padlock

6300 SERIES – HIGH SECURITY SOLID IRON SHROUDED PADLOCKS



Base Model	Description	Pack Qty	Min. Order Qty	Shackle Dimensions (Metric)		
				A	B	C
6321WP6	High Security Solid Iron Shrouded 54mm Wide Body	6	1	8mm	19mm	22mm
6325WP6	High Security Solid Iron Shrouded 61mm Wide Body	6	1	10mm	19mm	22mm
6327WP6	High Security Solid Iron Shrouded 67mm Wide Body	6	1	11mm	19mm	22mm

6100 SERIES WEATHER TOUGH® PADLOCKS



Base Model	Description	Pack Qty	Min. Order Qty	Shackle Dimensions (Metric)		
				A	B	C
6121WP6	Weather Tough 54mm Wide Body	6	1	8mm	29mm	22mm
6121LFWP6	Weather Tough 54mm Wide Body	6	1	8mm	38mm	22mm
6121LJWP6	Weather Tough 54mm Wide Body	6	1	8mm	63mm	22mm
6121LNWP6	Weather Tough 54mm Wide Body	6	1	8mm	143mm	22mm
6121BWP6	Weather Tough 54mm Wide Body	6	1	8mm	29mm	22mm
6121BLJWP6	Weather Tough 54mm Wide Body	6	1	8mm	63mm	22mm
6121SSWP6	Weather Tough 54mm Wide Body - Stainless Steel Shackle	6	1	8mm	30mm	22mm
6121SSLJWP6	Weather Tough 54mm Wide Body - Stainless Steel Shackle	6	1	8mm	60mm	22mm
6125WP6	Weather Tough 61mm Wide Body	6	1	10mm	35mm	22mm
6125LJWP6	Weather Tough 61mm Wide Body	6	1	10mm	63mm	22mm
6127WP6	Weather Tough 67mm Wide Body	6	1	11mm	35mm	22mm
6127LHWP6	Weather Tough 67mm Wide Body	6	1	11mm	48mm	22mm
6127LJWP6	Weather Tough 67mm Wide Body	6	1	11mm	60mm	22mm

6200 SERIES – ROUND BODY SOLID STEEL PADLOCKS



Base Model	Description	Pack Qty	Min. Order Qty	Shackle Dimensions (Metric)		
				A	B	C
6230WP6	Solid Steel 64mm Wide Body	6	1	11mm	29mm	22mm
6230LHWP6	Solid Steel 64mm Wide Body	6	1	11mm	51mm	22mm

EDGE™ KEY CONTROL

7000 SERIES – HIGH SECURITY SOLID STEEL PADLOCKS



Base Model	Description	Pack Qty	Min. Order Qty	Shackle Dimensions (Metric)		
				A	B	C
7030WP6	High Security Solid Steel 40mm Wide Body	6	1	6mm	27mm	20mm
7030LFWP6	High Security Solid Steel 40mm Wide Body	6	1	6mm	40mm	20mm
7030LTWP6	High Security Solid Steel 40mm Wide Body	6	1	6mm	76mm	20mm
7040WP6	High Security Solid Steel 44mm Wide Body	6	1	8mm	30mm	23mm
7040LFWP6	High Security Solid Steel 44mm Wide Body	6	1	8mm	40mm	23mm
7040LJWP6	High Security Solid Steel 44mm Wide Body	6	1	8mm	61mm	23mm
7040LNWP6	High Security Solid Steel 44mm Wide Body	6	1	8mm	143mm	23mm
7040SSWP6	Weather Tough 54mm Wide Body - Stainless Steel Shackle	6	1	8mm	30mm	22mm
7040SSLJWP6	Weather Tough 54mm Wide Body - Stainless Steel Shackle	6	1	8mm	60mm	22mm
7050WP6	High Security Solid Steel 51mm Wide Body	6	1	9mm	37mm	23mm
7050LJWP6	High Security Solid Steel 51mm Wide Body	6	1	9mm	61mm	23mm
7045WP6	High Security Solid Steel Shrouded 40mm Wide Body	6	1	8mm	30mm	23mm
6270WP6	73mm Solid Steel Enclosed Shackle	6	1	9mm	N/A	N/A

6800 SERIES – HIGH SECURITY SOLID BRASS PADLOCKS



Base Model	Description	Pack Qty	Min. Order Qty	Shackle Dimensions (Metric)		
				A	B	C
6840WP6	Solid Brass 40mm Wide Body - Boron Shackle	6	1	8mm	30mm	23mm
6840LFWP6	Solid Brass 40mm Wide Body - Boron Shackle	6	1	8mm	40mm	23mm
6840LJWP6	Solid Brass 40mm Wide Body - Boron Shackle	6	1	8mm	62mm	23mm
6840LNWP6	Solid Brass 40mm Wide Body - Boron Shackle	6	1	8mm	143mm	23mm
6840BWP6	Solid Brass 40mm Wide Body - Brass Shackle	6	1	8mm	30mm	23mm
6840BLJWP6	Solid Brass 40mm Wide Body - Brass Shackle	6	1	8mm	62mm	23mm
6840SSWP6	Solid Brass 40mm Wide Body - Stainless Steel Shackle	6	1	8mm	30mm	23mm
6840SSLJWP6	Solid Brass 40mm Wide Body - Stainless Steel Shackle	6	1	8mm	62mm	23mm



CHECK LIST

Item Code	Description
Component & Upgrade Options	
WP6DBCUTKEY	Extra Cut Keys Suit Edge Padlock
KRCHARGE	Key Retaining Charge Per Padlock

6800 SERIES – ALUMINIUM BODY REKEYABLE PADLOCKS



6835

- 40mm wide aluminum body.
- Baked on powder-coated finish stays bright.
- Ideal for corrosive and tough environments.
- Highly visible colours.
- Keyed different 5-pin tumbler cylinder.
- 6-pin cylinder available.
- Lifetime warranty.

TIP

For added pick resistance upgrade your padlocks to the Master Lock 6 pin W7000 profile – Item Code: 6PINCHARGE

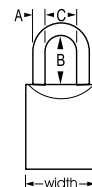

Base Model	Description	Pack Qty	Min. Order Qty	Shackle Dimensions (Metric)		
				A	B	C
Key Retaining unless otherwise specified						
6835BLK	Aluminium Powder Coated 40mm Wide Body – Black – Boron Shackle	6	1	6mm	27mm	20mm
6835BLU	Aluminium Powder Coated 40mm Wide Body – Blue – Boron Shackle	6	1	6mm	27mm	20mm
6835GRN	Aluminium Powder Coated 40mm Wide Body – Green – Boron Shackle	6	1	6mm	27mm	20mm
6835ORJ	Aluminium Powder Coated 40mm Wide Body – Orange – Boron Shackle	6	1	6mm	27mm	20mm
6835RED	Aluminium Powder Coated 40mm Wide Body – Red – Boron Shackle	6	1	6mm	27mm	20mm
6835YLW	Aluminium Powder Coated 40mm Wide Body – Yellow – Boron Shackle	6	1	6mm	27mm	20mm
6835LFBK	Aluminium Powder Coated 40mm Wide Body – Black – Extd Boron Shackle	6	1	6mm	40mm	20mm
6835LFBLU	Aluminium Powder Coated 40mm Wide Body – Blue – Extd Boron Shackle	6	1	6mm	40mm	20mm
6835LFGRN	Aluminium Powder Coated 40mm Wide Body – Green – Extd Boron Shackle	6	1	6mm	40mm	20mm
6835LFORJ	Aluminium Powder Coated 40mm Wide Body – Orange – Extd Boron Shackle	6	1	6mm	40mm	20mm
6835LFRED	Aluminium Powder Coated 40mm Wide Body – Red – Extd Boron Shackle	6	1	6mm	40mm	20mm
6835LFYLW	Aluminium Powder Coated 40mm Wide Body – Yellow – Extd Boron Shackle	6	1	6mm	40mm	20mm
6835LTBLK	Aluminium Powder Coated 40mm Wide Body – Black – Extd Boron Shackle	6	1	6mm	72mm	20mm
6835LTBLU	Aluminium Powder Coated 40mm Wide Body – Blue – Extd Boron Shackle	6	1	6mm	72mm	20mm
6835LTGRN	Aluminium Powder Coated 40mm Wide Body – Green – Extd Boron Shackle	6	1	6mm	72mm	20mm
6835LTORJ	Aluminium Powder Coated 40mm Wide Body – Orange – Extd Boron Shackle	6	1	6mm	72mm	20mm
6835LTRED	Aluminium Powder Coated 40mm Wide Body – Red – Extd Boron Shackle	6	1	6mm	72mm	20mm
6835LTYLW	Aluminium Powder Coated 40mm Wide Body – Yellow – Extd Boron Shackle	6	1	6mm	72mm	20mm

Please specify Keyed To Differ (KD) or Keyed Alike (KA) on your order.



CHECK LIST

Item Code	Description
Component & Upgrade Options	
CUTKEYCOM	Extra Cut Keys
HSK	Hard Stamp Numbering On Keys
KACHARGE	Keyed Alike to Specific Key Code Per Padlock
MKCHARGE	Master Keying Charge Per Padlock
KRCHARGE	Key Retaining Charge Per Padlock
ENGCOM	Engraving Per Side

LAMINATED / SOLID BODY

REKEYABLE LAMINATED STEEL PADLOCKS



0021

0025

0027

- Double locking mechanisms provide extra pry resistance.
- Hardened boron alloy shackles – No. 25 and 27.
- Hardened steel shackles – No. 21.
- Hardened steel bottom plates for extra drill resistance.
- Top and bottom bumpers for greater scratch resistance.
- Lifetime warranty.

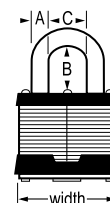

Item Code	Description	Pack Qty	Min. Order Qty	Shackle Dimensions (Metric)		
				A	B	C
0021K	Rekeyable Laminated Steel Padlock 44mm Wide Body – Hardened Steel Shackle	6	1	8mm	24mm	19mm
0025K	Rekeyable Laminated Steel Padlock 51mm Wide Body – Boron Alloy Shackle	6	1	10mm	25mm	24mm
0027K	Rekeyable Laminated Steel Padlock 51mm Wide Body – Boron Alloy Shackle	6	1	11mm	25mm	19mm

Item Code	Description
Component options – To the Lock	
CUTKEYCOM	Extra Cut Keys
Component options – Keying Options	
KACHARGE	Keyed Alike to Specific Key Code Per Padlock
MKCHARGE	Master Keying Charge Per Padlock

Note: All locks are supplied Keyed To Differ using Master Lock 5 pin, #27 profile unless otherwise specified.

STAINLESS STEEL LAMINATED PADLOCKS



5SSDAU

1SSDLFAU

- Stainless steel lock body and shackle delivers maximum weather resistance.
- Brass pin tumbler cylinder for increased weather and pick resistance.
- Double locking levers for increased pry resistance.

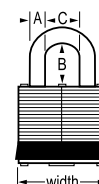

Item Code	Description	GTIN	Pack Qty	Min. Order Qty	Shackle Dimensions (Metric)		
					A	B	C
1SSDLFAU *	Stainless Steel 44mm Wide Body – Stainless Steel Shackle	071649264320	6	1	8	38	19
1SSTLFAU *	Stainless Steel 44mm Wide Body – Stainless Steel Shackle – 2 Pack KA	071649270000	6	1	8	38	19
1SSQLFAU *	Stainless Steel 44mm Wide Body – Stainless Steel Shackle – 4 Pack KA	071649264337	6	1	8	38	19
5SSDAU *	Stainless Steel 51mm Wide Body – Stainless Steel Shackle	071649264375	6	1	10	25	24
5SSTAU *	Stainless Steel 51mm Wide Body – Stainless Steel Shackle – 2 Pack KA	071649264382	6	1	10	25	24

* COMING SOON

Distributed exclusively by



CALL 1300 360 211

GENERAL USE HASPS

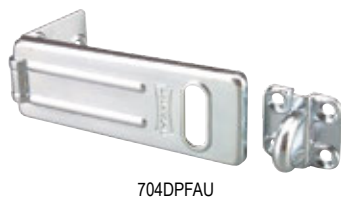

704DPFAU

- Hard-wrought steel bodies for strength.
- Hardened steel staples resist cutting and sawing.
- Hardened steel locking eyes for strong cut resistance.
- Tamper proof hinges help resist prying.

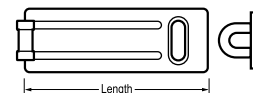

Item Code	Description	GTIN	Pack Qty	Min. Order Qty	Hasps Length	Accepts Shackle Dia. Up to:
702DAU	64mm Hard Wrought Steel Body Hasp	071649447006	4	4	64mm	7mm
703DAU	89mm Hard Wrought Steel Body Hasp	071649447105	4	4	89mm	9mm
704DPFAU	110mm Hard Wrought Steel Body Hasp	071649447204	4	4	110mm	13mm

HINGED HASPS



720DPFAU



721DPFAU



722DPFAU

- Secure hard-to-lock property.
- Hardened steel body for added strength.
- Hardened boron alloy staples resist cutting and sawing.
- Single and double hinge styles with hidden hinge pins.
- Ideal for reaching around corners and angles.

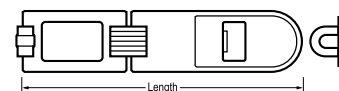

Item Code	Description	GTIN	Pack Qty	Min. Order Qty	Hasps Length	Accepts Shackle Dia. Up to:
720DPFAU	160mm Single-Hinge Hasp	071649074776	4	4	160mm	11mm
721DPFAU	200mm Single-Hinge Hasp	071649074790	4	4	200mm	11mm
722DPFAU	200mm Double-Hinge Hasp	071649074813	4	4	200mm	11mm

HEAVY DUTY HASP



730DPFAU

- Zinc plated hardened steel for added strength and weather resistance.
- Hardened steel staple resists cutting, sawing and hammering.
- Hasp body conceals mounting hardware.
- Mounting hardware included for easy installation.
- Ideal for utility vans, trailers and vending machines.

Item Code	Description	GTIN	Pack Qty	Min. Order Qty	Hasps Length	Accepts Shackle Dia. Up to:
730DPFAU	180mm Straight Bar Hasp	071649042737	4	4	180mm	11mm

KEYED ALIKE & KEYED TO DIFFER PROGRAMS

Master Lock products in most cases are available in keyed alike and master keyed formats either ex-stock or built to your exclusive order requirements in our keying cell. For details on all options please contact your Mayo Hardware representative or call Mayo Hardware Customer Service on 1300 360 211.

DIAMOND BRASS PADLOCKS



- Stylish and strong solid brass lock body.
- Standard steel and hardened steel shackles available.
- Diamond Quality – Lifetime Warranty.

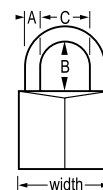

Item Code	Description	Pack Qty	Min. Order Qty	Key Profile	Shackle Dimensions (Metric)		
					A	B	C
Available Keyed Alike (Box Pack) Or Keyed To Differ (Hang Sell)							
0120	Diamond Brass 20mm Wide Body – Steel Shackle	12	1	120K	4mm	11mm	6mm
0130	Diamond Brass 30mm Wide Body – Steel Shackle	12	1	130K	5mm	16mm	14mm
0140	Diamond Brass 40mm Wide Body – Steel Shackle	12	1	130K	6mm	22mm	21mm
0140LF	Diamond Brass 40mm Wide Body – Extd Steel Shackle	12	1	130K	6mm	38mm	21mm
0150	Diamond Brass 50mm Wide Body – Steel Shackle	12	1	150K	7mm	25mm	25mm
640DAU [§]	Nickel Plated Brass 40mm Wide Body – Stainless Steel Shackle	12	1	130K	6mm	22mm	21mm
Not Available Master Keved							

§ Available Keyed Differ Only

Please specify Keyed To Differ (KD) or Keyed Alike (KA) on your order.

ECONOMY BRASS PADLOCK



4140

- Entry level solid brass lock body.
- Steel shackles available.
- 2 Year Warranty.

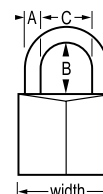

Item Code	Description	Pack Qty	Min. Order Qty	Key Profile	Shackle Dimensions (Metric)		
					A	B	C
Available Keyed Alike (Box Pack) Or Keyed To Differ (Hang Sell)							
4140	Brass 40mm Wide Body – Steel Shackle	12	1	130K	6mm	20mm	20mm
Not Available Master Keved							

Please specify Keyed To Differ (KD) or Keyed Alike (KA) on your order.

Distributed exclusively by

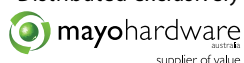

CALL 1300 360 211

LAMINATED NON REKEYABLE PADLOCKS



1DLJAU

3DAU

5DAU

- Strong laminated steel bodies for superior strength over brass locks.
- Hardened steel and boron alloy shackles for superior cut resistance.
- Pin cylinder helps prevent picking.
- Dual locking levers provide extra pry resistance.
- Proprietary rust proofing for longer life.
- Lifetime warranty.

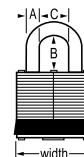

Item Code	Description	GTIN	Pack Qty	Min. Order Qty	Key Profile	Shackle Dimensions (Metric)		
						A	B	C
Available Keyed Alike (Box Pack) Or Keyed To Differ (Hang Sell)								
3DAU	Laminated Steel 40mm Wide Body – Steel Shackle	071649320606	4	4	1K	7mm	19mm	16mm
3DLFAU	Laminated Steel 40mm Wide Body – Extd Steel Shackle	071649320705	4	4	1K	7mm	38mm	16mm
1DAU	Laminated Steel 44mm Wide Body – Steel Shackle	071649305702	4	4	1K	8mm	24mm	19mm
1DLJAU	Laminated Steel 44mm Wide Body – Extd Steel Shackle	071649305757	6	1	1K	8mm	64mm	19mm
5DAU	Laminated Steel 51mm Wide Body – Boron Shackle	071649335105	4	4	1K	10mm	25mm	24mm
17DAU	Laminated Steel 51mm Wide Body – Boron Shackle	071649011177	6	1	17K	11mm	25mm	19mm
17LHAU	Laminated Steel 51mm Wide Body – Extd Boron Shackle	071649359507	6	1	17K	11mm	51mm	19mm

SPECIAL APPLICATION LOCKS



312DAU

- 40mm wide laminated steel body for superior strength.
- High-tech thermoplastic shell designed to withstand the elements.
- Hardened steel shackle.
- Ideal for all outdoor applications.
- Lifetime warranty.



0040D

- 70mm wide stainless steel body resists corrosion.
- Hardened steel shackle for extra cut resistance.
- Double deadbolt locking to guard against pulling.
- Key retaining feature ensures padlock is not left unlocked.
- Ideal protection against bolt cutter attacks.

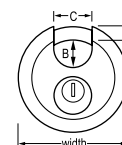

Item Code	Description	GTIN	Pack Qty	Min. Order Qty	Key Profile	Shackle Dimensions (Metric)		
						A	B	C
Available Keyed Alike (Box Pack) Or Keyed To Differ (Hang Sell)								
312DAU	Laminated Steel Thermoplastic Blue 40Mm Wide Body - Steel Shackle	071649050381	4	4	1K	10mm	25mm	13mm
0040D	Stainless Steel 70mm Wide Body – Steel Shackle	071649030147	4	4	1K	10mm	19mm	19mm

Please specify Keyed To Differ (KD) or Keyed Alike (KA) on your order.

KEYED ALIKE & KEYED TO DIFFER PROGRAMS

UNIVERSAL PIN LOCKS (CRUNCHER) – BOX PACK

Master Lock's range of Universal Pin (Cruncher) Locks, allows you to add extra locks to your existing key profile 1K padlock system in a matter of minutes! Minimise your customers' keys and maximise your padlock sales with this innovative solution from Master Lock.

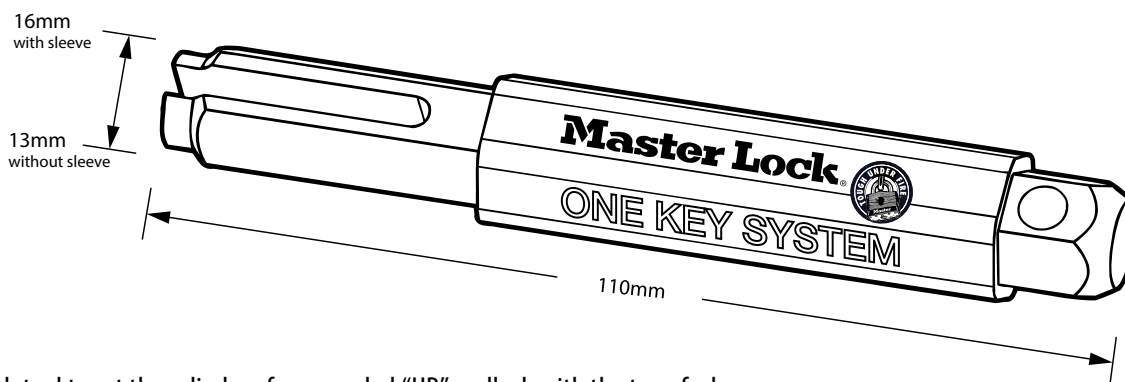

Punch tool to set the cylinder of an uncoded "UP" padlock with the tap of a hammer.

KEYING INSTRUCTIONS:

1. Choose original Master Lock padlock key to be used and remove from ring.
2. Insert key into Master Lock "UP" series padlock and remove several times.
3. Insert key into Master "UP" series lock and invert padlock through the jaws of your bench vise. Do not tighten vise.
4. Place No. 0376 Keying Tool over key and tap with hammer until cylinder pins shear.
5. Remove padlock from vise and check for proper operation, turning key in lock several times.

WHEN USING ANY TYPE OF STRIKING TOOL, WEAR SAFETY GLASSES!

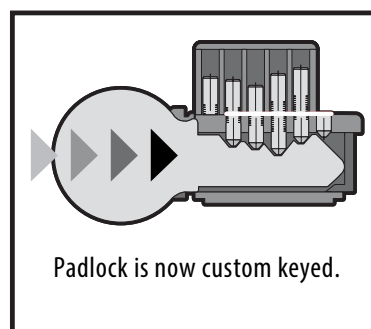
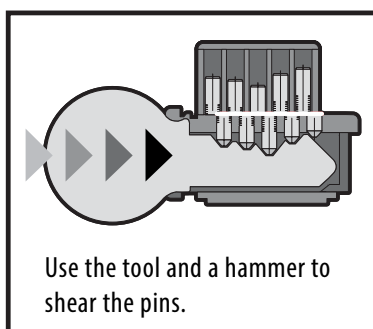
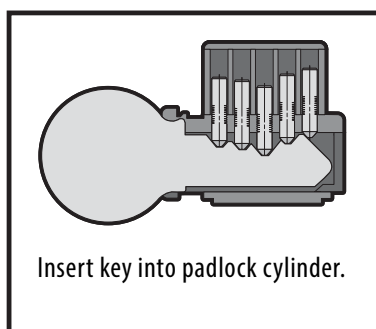

Item Code	Description	GTIN	Pack Qty	Min. Order Qty	Key Profile	Shackle Dimensions (Metric)		
						A	B	C
Available Keyed Alike Or Keyed To Differ								
0003UP	Laminated Steel 40mm Wide Body – Steel Shackle	071649079757	6	1	1K	7mm	19mm	16mm
0003UPLF	Laminated Steel 40mm Wide Body – Extd Steel Shackle	071649083976	6	1	1K	7mm	38mm	16mm
0001UP	Laminated Steel 44mm Wide Body – Steel Shackle	071649079740	6	1	1K	8mm	24mm	19mm
0001UPLJ	Laminated Steel 44mm Wide Body – Extd Steel Shackle	071649083983	6	1	1K	8mm	64mm	19mm
0005UP	Laminated Steel 51mm Wide Body – Boron Shackle	071649079764	6	1	1K	10mm	25mm	24mm
0005UPLF	Laminated Steel 51mm Wide Body – Extd Boron Shackle	071649083990	6	1	1K	10mm	38mm	24mm
0376	Hand-Held Keying Punch Tool	-	1	1	N/A	-	-	-
0001B	Key Blanks For Universal Locks	071649481000	50	1	N/A	-	-	-

Distributed exclusively by

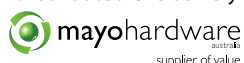

CALL 1300 360 211

2000 SERIES – NEW GENERATION HIGH SECURITY PADLOCKS



2010

- 55mm wide double-armoured stainless steel body.
- Double ball bearing locking shackle resists prying.
- Hardened boron alloy shackle for superior cut resistance.
- 3 times stronger than No.1500 model.
- Key override for supervisory access.
- Ideal for protecting high value property such as laptop or iPad.

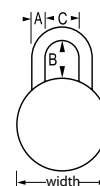

Item Code	Description	Pack Qty	Min. Order Qty	Shackle Dimensions (Metric)		
				A	B	C
2010	Combination Dial Black 55mm Wide Body – Boron Alloy Shackle – Key Override	50	1	8mm	25mm	24mm
2010K	Control Override Key For 2010 Lock	-	-	-	-	-

1500 SERIES – GENERAL SECURITY SOLUTION PADLOCKS



1525LH

1525LF

1525

- 48mm wide double-armoured stainless steel body.
- Hardened steel shackle for extra cut resistance.
- Combination security for keyless convenience.

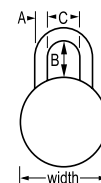

Item Code	Description	Pack Qty	Min. Order Qty	Shackle Dimensions (Metric)		
				A	B	C
Standard						
1502	Combination Dial Black 48mm Wide Body – Steel Shackle	100	1	7mm	19mm	21mm
1502C	Combination Dial Coloured 48mm Wide Body – Steel Shackle	100	1	7mm	19mm	21mm
1502LF	Combination Dial Black 48mm Wide Body – Extd Steel Shackle	100	1	7mm	38mm	21mm
1502LH	Combination Dial Black 48mm Wide Body – Extd Steel Shackle	100	1	7mm	51mm	21mm
Key Override Models						
1525	Combination Dial Black 48mm Wide Body – Steel Shackle – Key Override	100	1	7mm	19mm	21mm
1525C	Combination Dial Coloured 48mm Wide Body – Steel Shackle – Key Override	100	1	7mm	19mm	21mm
1525LF	Combination Dial Black 48mm Wide Body – Extd Steel Shackle – Key Override	100	1	7mm	38mm	21mm
1525LH	Combination Dial Black 48mm Wide Body – Extd Steel Shackle – Key Override	100	1	7mm	51mm	21mm
1525K	Control Override Key For 1525 Locks	-	-	-	-	-

LOCKER MANAGEMENT SOLUTIONS

SPECIAL NEEDS PADLOCKS



2650

- Designed to assist those with limited mental or physical abilities.
- Specially selected, easy to remember combinations with key override (1525EZRC).
- Simply insert key to open – no turning (2650).

Item Code	Description	GTIN	Pack Qty	Min. Order Qty	Shackle Dimensions (Metric)		
					A	B	C
1525EZRC	Simple Combination Dial Black 48mm Wide Body – Steel Shackle	071649402005	100	1	7mm	19mm	21mm
2650	PushKey™ Portable Lock – Steel Shackle	071649093371	24	1	7mm	19mm	21mm

1600 SERIES – LONG LIFE FITTED LOCKS



1670

- End user registration and control charts provided to secure and simplify administration.
- Secure, easy-to-dial three digit combination.
- Longer useful life with five different, pre-set combinations.
- Easily changed with the touch of a button.
- Helps maintain security for new students or employees.

Item Code	Description	Pack Qty	Min. Order Qty
Deadbolt Style			
1670	Built-in Combination Lock – Hinged Right	50	1
1671	Built-in Combination Lock – Hinged Left	50	1
Extensions			
1654-0320	Extension Set For 19mm Timber Doors	1	1



CHECK LIST

LOGO PRINT

Item Code	Description
PADPRINT	Logo Added To 1525 Or 1502 – Colour Dial Price
PADPRINTSETUP	Set Up Charge For Logos

PADLOCK EYES



0060



0060R

Item Code	Description	GTIN	Pack Qty	Min. Order Qty
0060	Padlock Eyes Flat – Shackles Up To 13mm (Per Pair)	9316861162704	12	1
0060R	Padlock Eyes Right Angle – Shackles Up To 13mm	071649484506	6	1

Distributed exclusively by

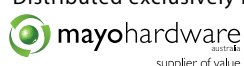

CALL 1300 360 211

HEAVY DUTY RESETTABLE COMBINATION PADLOCKS



175DAU



0178



1174D

- Heavy-duty grade.
- Set-your-own combination convenience.
- 4 digit dialing allows for thousands of possible combinations.
- Resettable to any of 10,000 personalised combinations.
- Change combination with change key at any time.
- Hardened steel shackle provides maximum cut resistance.
- 1174D is constructed from grade 316 stainless steel and has a dial cover making this lock ideal for corrosive environments.

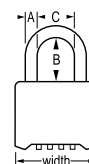

Item Code	Description	GTIN	Pack Qty	Min. Order Qty	Shackle Dimensions (Metric)		
					A	B	C
175DAU	Combination 51mm Brass Body – Hardened Steel Shackle	071649395604	4	1	8mm	25mm	25mm
175DLHAU	Combination 51mm Brass Body – Hardened Steel Shackle	071649395505	6	1	8mm	57mm	25mm
0178	Combination 51mm Die Cast Body – Hardened Steel Shackle	071649048524	6	1	8mm	25mm	25mm
1174D	Combination 57mm Stainless Steel Body – Stainless Steel Shackle	071649149580	4	1	8mm	28mm	25mm

BLUETOOTH SMART CONNECTED PADLOCKS



4400DAU

4401DLHAU

- Solid zinc lock body.
- Boron steel shackle for superior cut resistance.
- Outdoor padlock features a full 2-piece injection moulded body cover and shackle seals for weather resistance.
- No key or combination required – padlock opens using Bluetooth signal.
- Schedule guest access 24/7, or limit to days or nights.
- Monitor padlock activity via smart phone app.
- Receive email and app notifications of unsuccessful padlock entry attempts.
- No charging required (readily available long life batteries included).
- Minimum 1 year battery life (CR2 Battery – Indoor CR2450 Battery – Outdoor).
- Store unique backup master code on Master Lock Vault app eLocks.

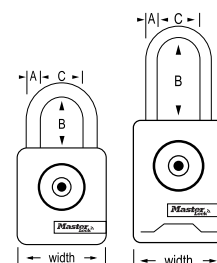

Item Code	Description	GTIN	Pack Qty	Min. Order Qty	Shackle Dimensions (Metric)		
					A	B	C
4400DAU	Bluetooth Padlock – Indoor	071649266591	2	1	7mm	22mm	20mm
4401DLHAU	Bluetooth Padlock – Outdoor	071649276002	2	1	9mm	51mm	23mm

COMBINATION & COMPUTER LOCKS

COMBINATION PADLOCKS



647DAU



646DAU



1500DAU

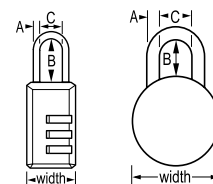

Item Code	Description	GTIN	Pack Qty	Min. Order Qty	Shackle Dimensions (Metric)		
					A	B	C
646DAU	Combination Resettable 20mm Die Cast Case	071649080036	4	4	3mm	22mm	9mm
647DAU	Combination Resettable 30mm Die Cast Case	071649080050	4	4	5mm	24mm	14mm
1500DAU	Combination Dial 48mm Double Armour Stainless Steel Body 3 Digit Dialing	071649396502	6	6	7mm	19mm	21mm

COMPUTER LOCKS



- Secure devices on campus, in the office, while travelling or when at home.
- Strong ultra-portable self coiling cable extends from 76mm to 1.8m.
- Durable metal construction.
- Easy to use set your own combination with up to 10,000 possible combinations.
- Ideal for securing laptop computers, monitors, projectors and other peripheral devices.

Item Code	Description	GTIN	Pack Qty	Min. Order Qty
2120D	Computer Lock – Combination	071649176975	4	1

CABLE LOCKS



- Ideal for ladders, generators, toolboxes and gates.
- Combination locking mechanisms for keyless convenience.
- Flexible steel cables for strong cut resistance.
- Protective coating helps prevent scratching.
- Features 4 digit resettable combination.

Item Code	Description	GTIN	Pack Qty	Min. Order Qty
8119DPFAU	Cable Lock Combination 1.5m x 10mm Diameter	071649035838	4	4
8154DPFAU	Cable Lock Bike Keyed 1.8m x 10mm Diameter	071649042713	4	4
8155DCCA	Cable Lock Bike Keyed 1.8m x 15mm Diameter	071649042720	2	2
8233EURDPROCOLAU	Cable lock – 4-Digit Combination; 1.8m x 8mm; Assorted Bright Colours 2 Of Each Colour Per Inner Pack	3520190934512	6	6

PYTHON ADJUSTABLE CABLE LOCKS



- Patented locking mechanism holds the cable tight at any position from 300mm to 1.8m for infinite locking positions.
- Rekeyable cylinders for keyed alike convenience.
- Available Keyed alike to any standard M1 key cut.
- 100% steel braided cable.
- Weather tough and rust-resistant lock body.
- Vinyl sleeve and lock body bumper prevents scratching.
- Velcro strap holds excess cable for compact storage.

Item Code	Description	GTIN	Pack Qty	Min. Order Qty	Key Profile
8428DCCA	Python Contractor Cable Lock Complete With 1.8 Metre Cable	3520190941053	4	4	1K

HOW TO OPERATE

1. UNLOCK



In the "UNLOCK" position, the flexible steel cable moves freely through the Python lock.

2. CINCH



In the "CINCH" mode, the exclusive locking mechanism permits the cable to be pulled tight without slipping back.

3. LOCK



In the "LOCK" position the Python lock secures the cable at the perfect length for the job!

CABLES & CHAINS

HEAVY DUTY CABLES



72DPFAU

85DPFAU

- Braided steel cable for strength and flexibility.
- Convenient loops with rust-resistant sleeves and scratch guards.
- Galvanised steel cable resists rusting.
- Vinyl coating helps prevent scratching.
- Recommend use with high or maximum security padlocks.

Item Code	Description	GTIN	Pack Qty	Min. Order Qty	Coated Cable Length	Outside Dia. of Coated Cable
59DPFAU	3.0m x 10mm dia. Braided Steel Cable	3520190933799	4	4	3.0m	10mm
72DPFAU	4.6m x 10mm dia. Braided Steel Cable	071649036941	4	4	4.6m	10mm
78DPFAU	1.8m x 10mm dia. Braided Steel Cable	071649035876	4	4	1.8m	10mm
85DPFAU	1.2m x 10mm dia. Braided Steel Cable	071649005312	4	4	1.2m	10mm
70DCCAU	9.0m x 10mm dia. Braided Steel Cable	071649208775	3	3	9.0m	10mm

SECURITY CHAINS



- Hardened steel chain.
- Square link for better cut resistance.
- Vinyl thermoformed protective sleeve to prevent from scratching.
- Cut strength:
 - 6mm = 2500kgs
 - 8mm = 4000kgs
 - 10mm = 5000kgs
- Recommended use with high or maximum security padlocks.

Item Code	Description	GTIN	Pack Qty	Min. Order Qty	Coated Chain Length	Outside Dia. of Coated Chain
8011EURDAU	Security Chain	3520190933386	6	1	1.00m	6mm
8016EURDAU	Security Chain	3520190933430	4	1	1.00m	8mm
8018EURDAU	Security Chain	3520190933454	4	1	2.00m	8mm
8019EURDAU	Security Chain	3520190933461	4	1	1.00m	10mm
8020EURDAU	Security Chain	3520190933478	4	1	1.50m	10mm

SELECT ACCESS

- Holds up to 5 keys in a convenient location.
- Set-your-own 4-digit combination for keyless convenience.
- Reinforced body withstands hammering and sawing.
- Cover protects combination dials from weather, dirt and grime.
- Portable or wall mount options available.



5400DAU



5401DAU



5403EURDAU

Item Code	Description	GTIN	Pack Qty	Min. Order Qty	Internal Dimensions		
					H	W	D
5400DAU	Select Access Portable	071649214516	4	1	78mm	68mm	34mm
5401DAU	Select Access Wall Mount	071649214523	4	1	92mm	64mm	28mm
5403EURDAU	Select Access Maxi Wall Mount	3520190932297	4	1	117mm	79mm	42mm

HEAVY DUTY SELECT ACCESS

- Holds house and car keys, access cards and other valuables.
- Reinforced solid zinc alloy body for superior strength and reliability.
- Dual locking levers for extra pry resistance.
- Optimised storage capacity.
- Protective door for better weather resistance and greater discretion.
- 4-digit resettable combination.



5414EURDAU



5415EURDAU

Item Code	Description	GTIN	Pack Qty	Min. Order Qty	Internal Dimensions		
					H	W	D
5414EURDAU	Select Access Heavy Duty Portable	3520190935106	4	1	96mm	63mm	35mm
5415EURDAU	Select Access Heavy Duty Wall Mount	3520190935113	4	1	96mm	63mm	35mm

SELECT ACCESS KEY SAFES

SELECT ACCESS PUSH BUTTON

- Holds keys, cards and other personal items.
- Solid die cast body is reinforced to withstand hammering and sawing.
- Large push-buttons for ease of use.
- Automatic scrambling: Once you close the door, the lock is secured so no need to scramble numbers.
- Set your own combination using up to 12 letters, numbers, or both.
- Lock body covered with moulded bumper to prevent scratches to the door.
- Integrated keypad cover for protection against dirt and grime.



5412DAU



5422DAU



5423DAU

Item Code	Description	GTIN	Pack Qty	Min. Order Qty	Internal Dimensions		
					H	W	D
5412DAU	Select Access Push Button Wall Mount	3520190934697	4	1	95mm	60mm	20mm
5422DAU	Select Access Push Button Portable	071649188268	4	1	95mm	60mm	20mm
5423DAU	Select Access Push Button Wall Mount	071649188343	4	1	95mm	60mm	20mm

KEY CABINETS



7122D



7126D



7128D

- Heavy-duty steel construction with full length hinged door and built in slotted key racks.
- Durable powder coated beige finish.
- Key retaining ensures key cannot be removed until cabinet is locked.
- Includes 2 keys, key holders, cross reference chart and installation hardware.

Item Code	Description	GTIN	Pack Qty	Min. Order Qty	Size (Metric)		
					Height	Width	Depth
7122D	Heavy Duty Key Cabinet Holds 30 Keys	071649248535	4	1	305mm	203mm	64mm
7125D	Heavy Duty Key Cabinet Holds 60 Keys	071649248548	4	1	311mm	273mm	76mm
7126D	Heavy Duty Key Cabinet Holds 120 Keys	071649248573	4	1	432mm	330mm	83mm
7127D	Heavy Duty Key Cabinet Holds 240 Keys	071649248580	2	1	508mm	419mm	127mm
7128D	Heavy Duty Key Cabinet Holds 330 Keys	071649248587	2	1	508mm	419mm	127mm
7129	Heavy Duty Key Cabinet Holds 500 Keys	071649248603	1	1	641mm	457mm	140mm
7130	Heavy Duty Key Cabinet Holds 730 Keys	071649248610	1	1	641mm	457mm	178mm
7117D	Plastic Key Holder (20 Per Bag)	071649229060	10 Bags	1			

[illegible]